

4

Mount the top against the base by screwing 8 bolts crosswise through the base, inside the table top.

Note: When moving the table, it is necessary to disassemble the top from the base and repeat step 1 and 4.

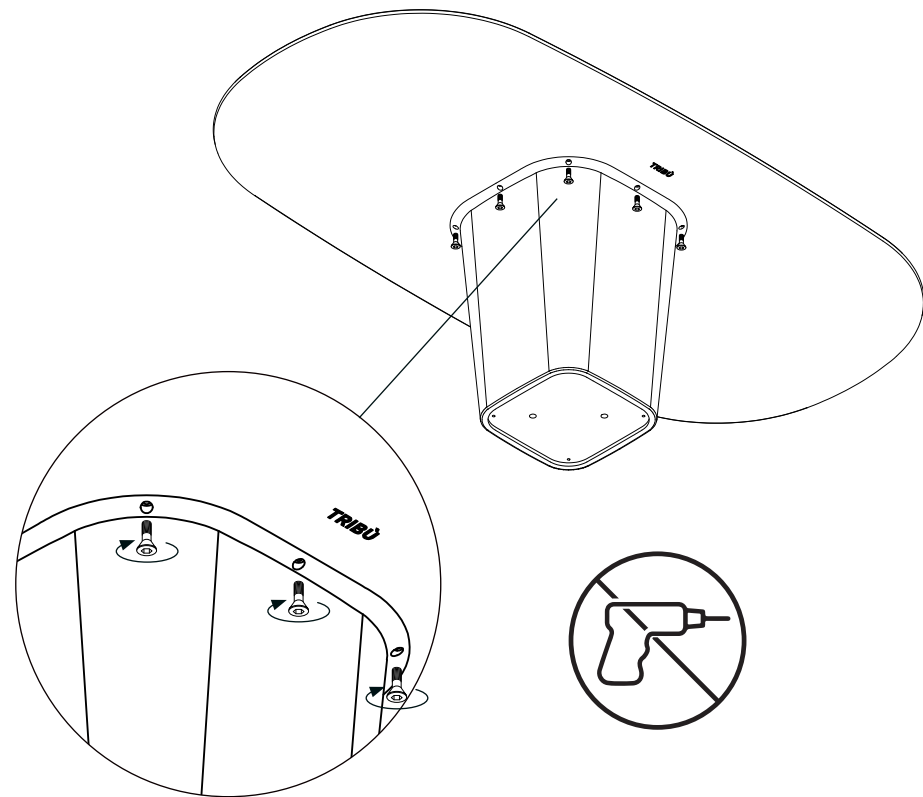

01670-XX

Tribù nv  
Oude Heidestraat 72  
3740 Bilzen  
BELGIUM

[www.tribu.com](http://www.tribu.com)  
[info@tribu.com](mailto:info@tribu.com)

**TRIBÙ**

ASSEMBLY INSTRUCTIONS

TAO  
oval dining table

CONTENT

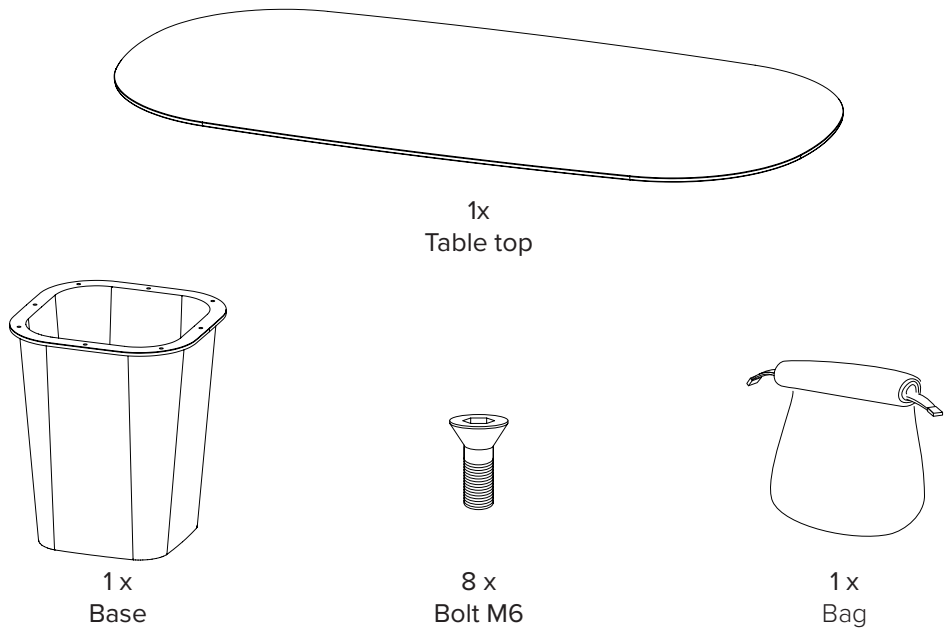

Not included, to be provided by costumer:



ASSEMBLY INSTRUCTIONS

1 Place the base on the correct location (moving the table can't be done when assembled).

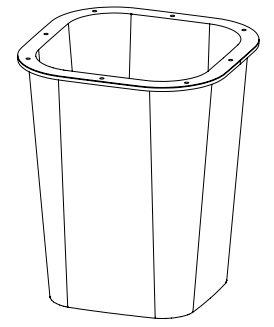

2 Place the supplied bag inside the base. Fill the bag at least half full with sand or pebbles (± 45kg).

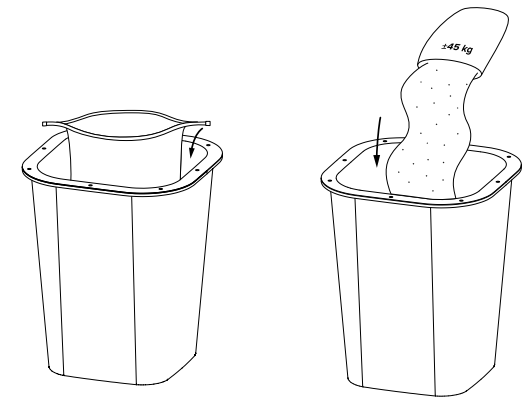

3 Close the bag by attaching the look and hoop strips against each other. Roll the closed bag down so most of the air inside the bag gets out. Lastly, attach the buckles against each other to keep the bag closed.

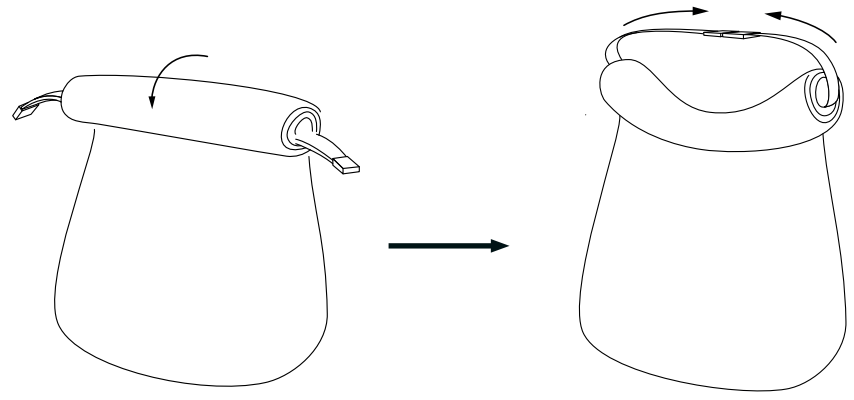

This step is done when the bag is inside the base and filled with sand or pebbles.